

Twickenham Rediscovered *Community Space and Diamond Jubilee Gardens workshop* 5th September 2016

Facilitator:

David Allister,

Head of Parks and Open Spaces

Agenda

- Welcome / introductions
- Setting the scene
 - Introduction to Diamond Jubilee Gardens (Hugh Brasher, Twickenham Riverside Trust)
- Key messages from past consultations
- Feedback from the pop-up shop
- Community Space and Diamond Jubilee Gardens
 - Session 1 – *What is community space?*
 - Session 2 – *How could community space be used on the site?*
 - Session 3 – *What could this community space look like?*
- Summary and next steps

Setting the scene

- ✓ Continuing engagement
- ✓ Reflection
- ✓ Richer and deeper conversation:
 - Viability
 - Retail and business
 - Community space / linkages
 - Access, parking, traffic
 - Connectivity to the River
 - Site configuration

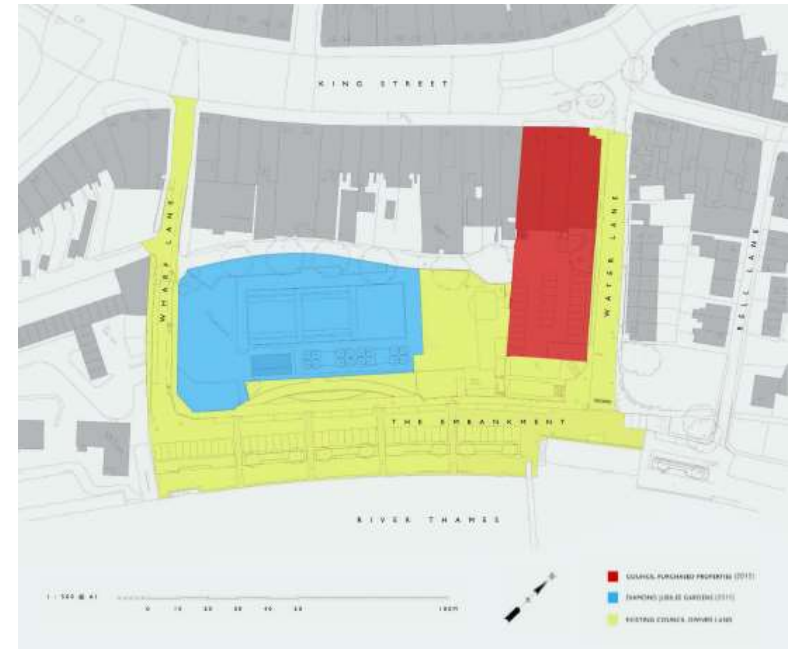

Workshop purpose

Today we will be looking at **Community Space** and links to **Diamond Jubilee Gardens**

Purpose – **Understand the desired use of the community space and inform the design**

- Open up discussion and debate
- Raise questions
- Receive and capture feedback
- Inform the broader discussion taking place through the workshop programme

Key messages from past consultations

Barefoot Consultation (2010):

- 85% of residents felt that developing the riverside was important
- Many suggested enhanced community space
- Following consultation, the Council created the award winning Diamond Jubilee Gardens, in partnership with local people

All in One Consultation (2010):

- 88% satisfied with your local area as a place to live
- For 70% of respondents, local parks and open spaces were most important in making Twickenham a good place to live

Twickenham Area Action Plan (2013):

- Set out ambition to:
 - Open up and redevelop/refurbish the remaining area of the former pool site
 - Upgrade of the Embankment south of the Diamond Jubilee Gardens to provide a pedestrian priority/shared surface with new landing facilities



Feedback from pop-up shop

Approximately 800 people visited the pop-up shop on Church St. Out of the 334 comment cards received, 55 of the responses were on the topic of Community Spaces and Diamond Jubilee Gardens. Snapshot of views below – consultation closes on 16th September.

Community Space

- Space for festivals and events
- Restaurants and cafes with alfresco dining
- Examples given include: a town square, performance space, space for community groups
- An extension to the footprint of Diamond Jubilee Gardens
- Hard or soft landscaping – mixed opinion
- Importance of links between gardens and the River

Session 1 – *What is community space?*

- What do we mean by community space?
 - Could community space mean buildings, open space and / or something else?

Session 2 – How could community space be used on the site?

What sort of activities and events would encourage more people to come to Twickenham?

Things to consider:

- Types of activity
- Balance of use
- Maximum numbers of attendees
- Access to water / electricity
- Controlled access

Current site plan

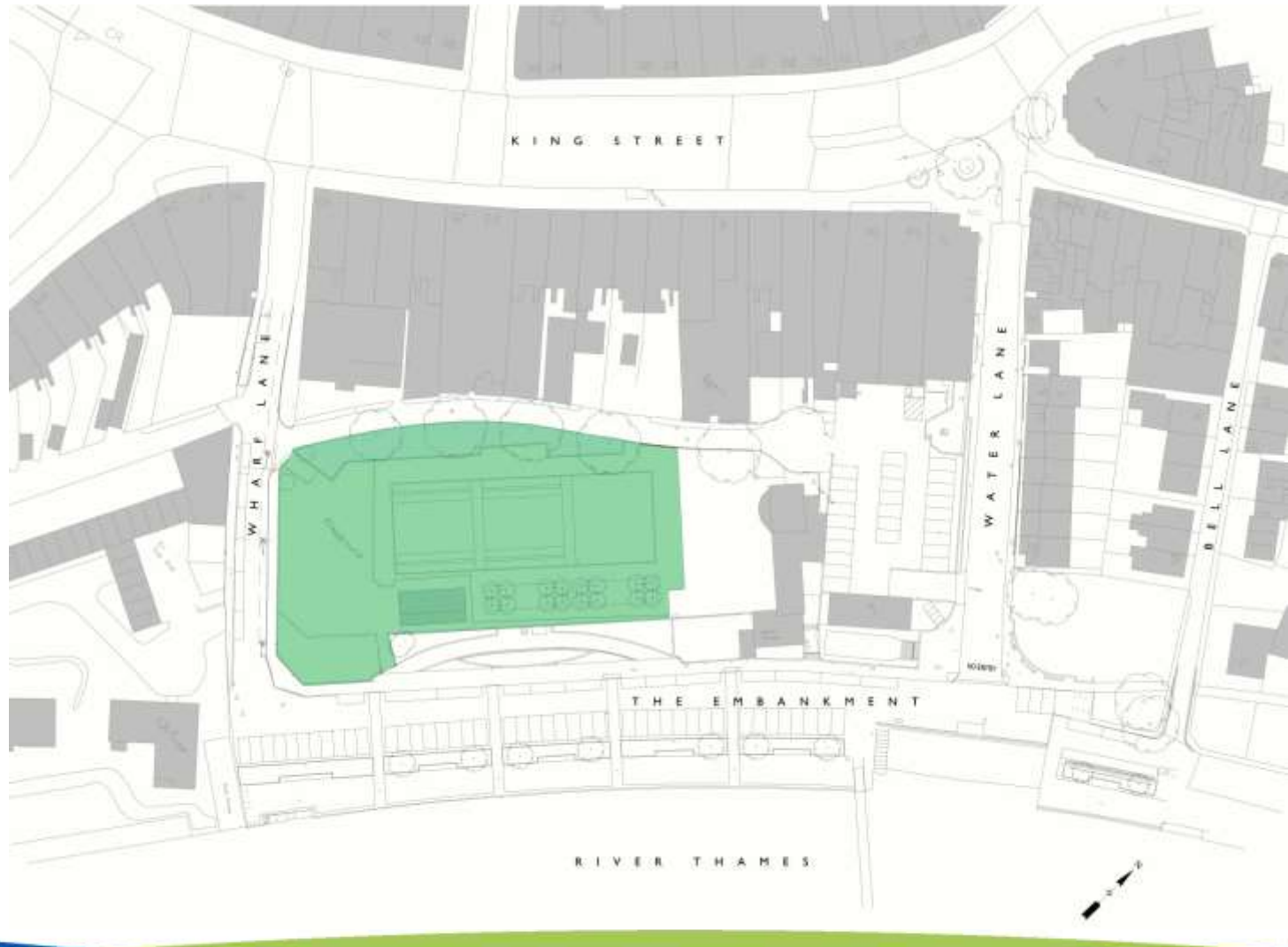

TWICKENHAM
REDISCOVERED

Session 3 – *What could this community space look like?*

Things to consider:

- *Buildings vs. open space and links to DJG*
- *Accessibility*
- *Open space – proportion of soft to hard landscaping, trees / floral / grasses*
- *Lighting*
- *Seating*
- *Preventing inappropriate uses*
- *Materials*
- *Maintenance (access)*



TWICKENHAM
REDISCOVERED



TWICKENHAM
REDISCOVERED

Summary

What we've heard tonight

TWICKENHAM
REDISCOVERED

What happens next?

- From late September onwards we will feedback what we have heard at the pop-up shop and the range of workshops
- From mid to late October we will present revised proposals and will consult you on them