

ARTICLE 4 DIRECTIONS CA4 RICHMOND RIVERSIDE

Effective Date: 12.07.2000

Old Palace Lane 14-25 (incl)
Park Road 2, 6-10 (even), 16-24 (even)
& 3-33 (odd)
Willoughby Road, Russell Villas 1 & 2

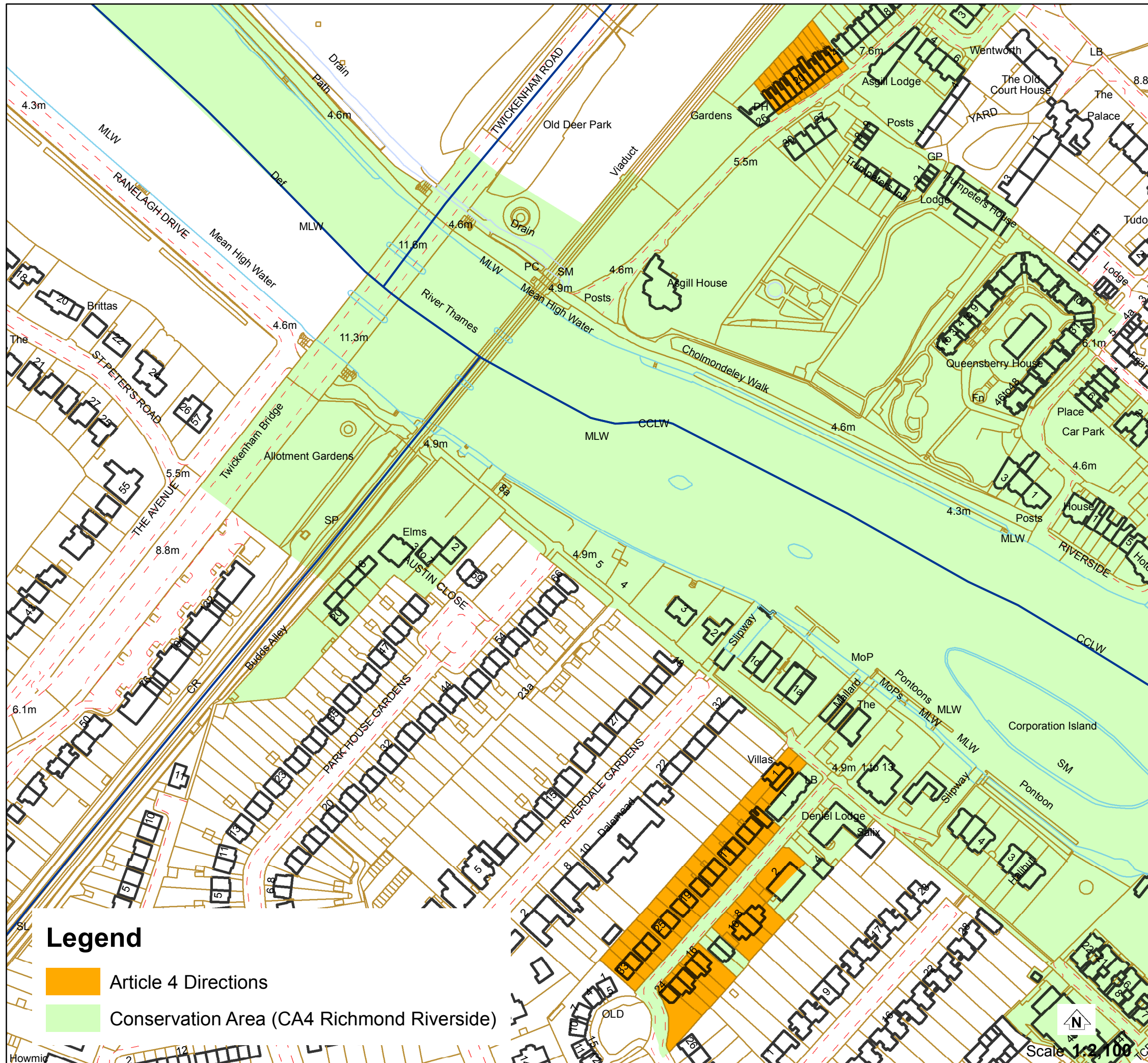

Civic Centre, 44 York Street, Twickenham TW1 3BZ
Tel: 020 8891 1411 Textphone: 020 8891 7120
www.richmond.gov.uk

Printed: 01/12/2015

Produced from our Corporate Geographic Information System
© Crown copyright and database rights 2015
Ordnance Survey 100019441

